

iVAC Fill Level Meter

“Maintain Accurate Dust Bin Levels”

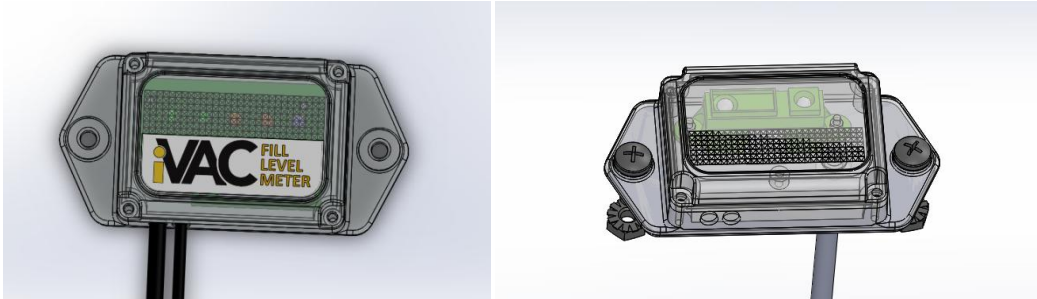

Display Module

Sensor Module

The iVAC Fill Level Meter consists of two main components, the LED Display module and an IR Sensor module, connected via dust and water proof cables. The Display module is powered with standard USB wall charger and has a series of five LED's indicating varying fill levels. The first two LED's are green, the next two are orange and the final “full” level is a flashing blue / red indicating a full bin to be emptied.

The sensor module is fixed to the underside of the lid of your dust bin perpendicular to the deepest area of your bin, and away from the central dust vortex, Fig “A”. The Sensor Module is backed with a foam dust gasket complete with 10-32 studs and lock nuts. A drawing is provided showing the hole sizes and location for drilling prior to installation, Figure “B”. Once the holes are drilled feed the cable through the center hole from the inside, fasten the unit to the lid with the nuts provided slightly compressing the foam gasket sealing the openings.

Tech Tip: When emptying your dust bin wipe the surface of the IR module with a soft cloth removing any excess dust or debris.

The LED module should be mounted in a visible location in your shop giving you warnings as your dust bin fills and the different LED's are illuminated. Connect the cables together as shown in Figure “C” lining up the arrows as you push the cable together. Once connected tighten the nut to secure the fittings. Plug the USB outlet into a receptacle and you are setup and ready to go. A good practice is before mounting to your dust bin connect the cables, plug the unit into an outlet, and run your hand toward and away from the Sensor Module to get an indication of the different LED levels. See the chart below for approximate LED level indications.

LED Indicator level:

First Green ~ 80 cm/31" or more (will be used as a power indicator.)

Second Green ~ 40 cm/16"

First Orange ~ 22 cm/9"

Second Orange ~ 15 cm/6"

Blinking Red/Blue ~ 10 cm/4" (Time to empty the bin)

Figure "A"

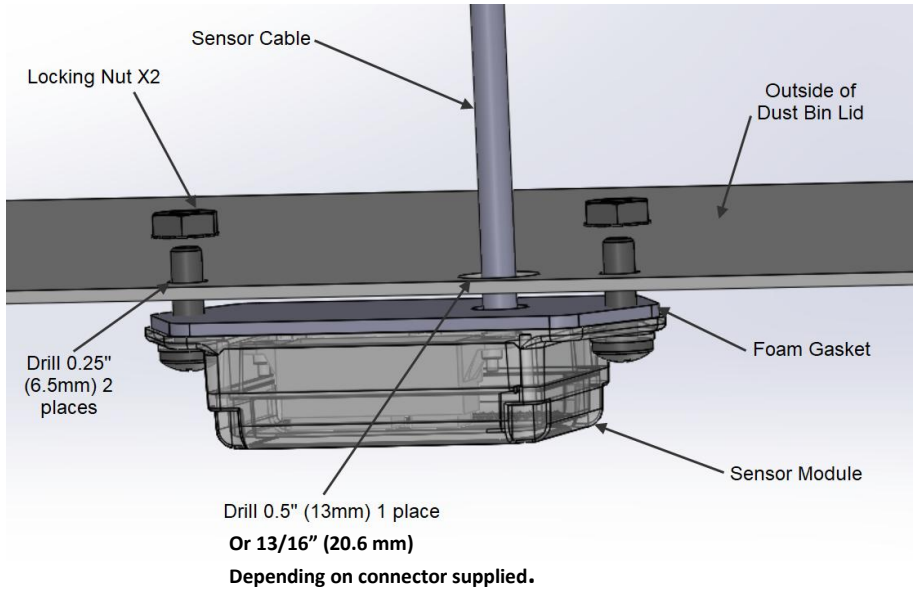

Figure "B"

Dust Bin Cover Drilling Template

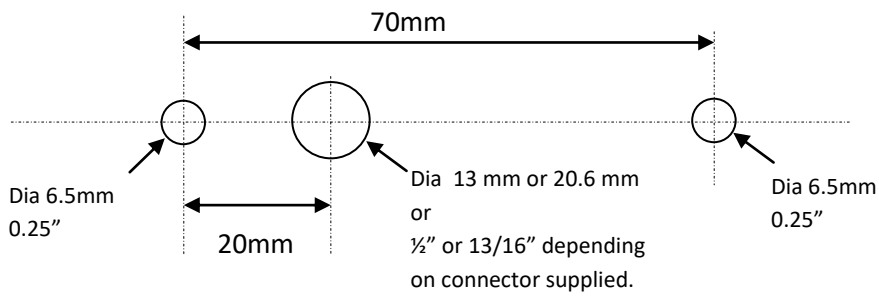

Figure "C"

